

**Read manual instructions about the rear body mount carefully. Several versions are included.**

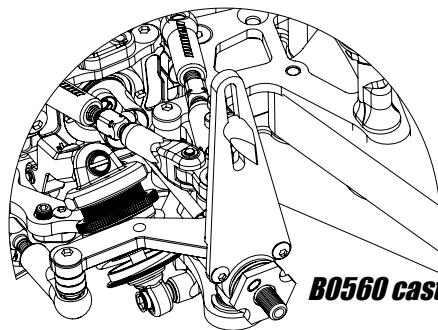

**B0560 caster angle tool** Opt

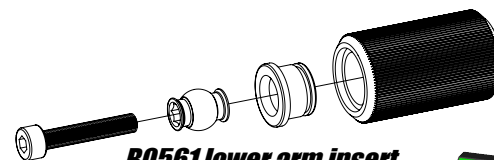

**B0561 lower arm insert tool (assemble/disassemble)** Opt

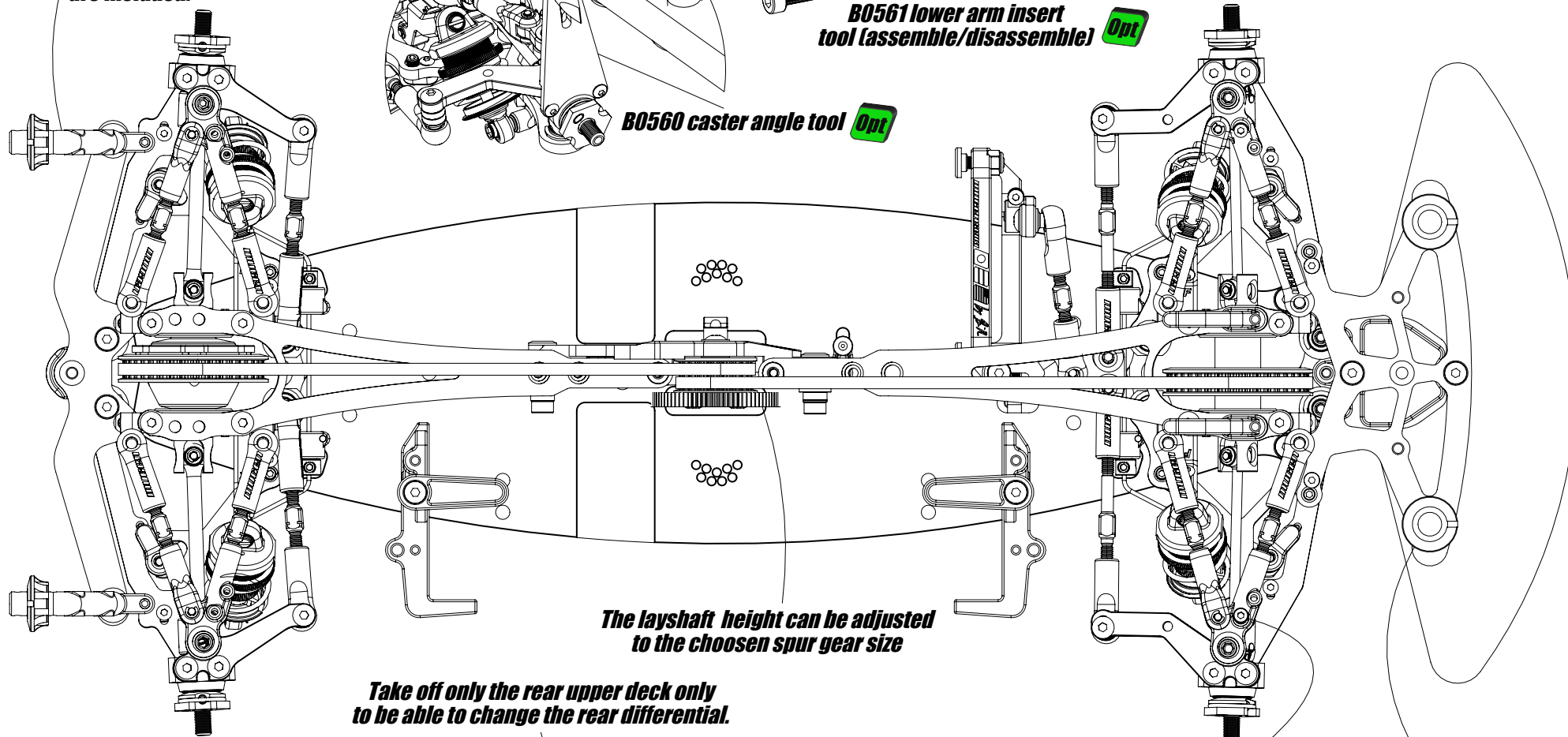

**The layshaft height can be adjusted to the chosen spur gear size**

**Take off only the rear upper deck only to be able to change the rear differential.**

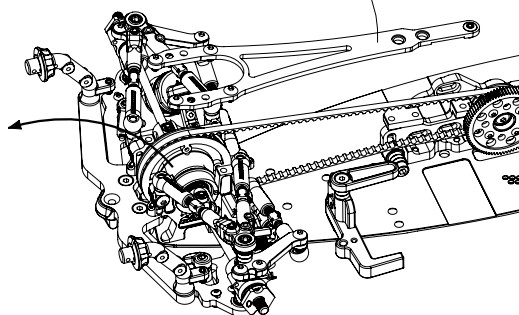

**Choose which position of the body post suits best to the wanted body shell (Narrow or wide)**

**Choose which position of the body stop screw suits best to the wanted body shell (inside or outside)**

***With the 1.5mm aluminium chassis you have a variety of flex settings. This makes a 2.25mm carbon chassis unnecessary. The COG would increase by ap. 0.75mm, which would have a big disadvantage.***

***Cut the bumper to the certain lower deck level with a hobby knife***

***Access holes for ackermann adjustment***

***Access to the the pinion set screw***

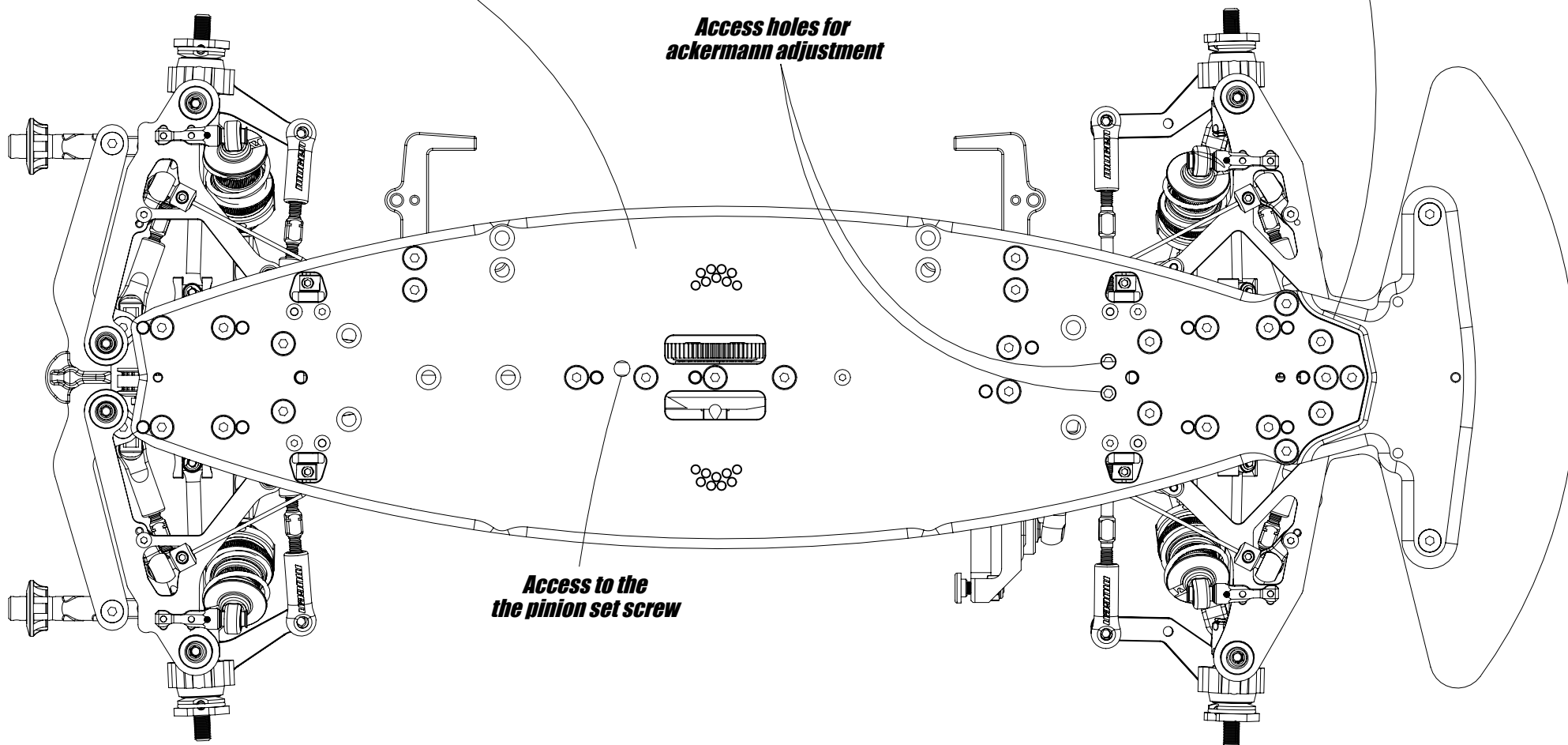

***It is recommended to use the wanted setup sheet  
aside throughout the assembly*** 

# Gearchart

	80	81	82	83	84	85	86	87	88	89	90	91	92	93	94	95	96
19																	
20																	
21																	
22																	8,291
23																7,848	7,930
24															7,442	7,521	7,600
25														7,068	7,144	7,220	7,296
26													6,723	6,796	6,869	6,942	7,015
27												6,404	6,474	6,544	6,615	6,685	6,756
28											6,107	6,175	6,243	6,311	6,379	6,446	6,514
29											5,897	5,962	6,028	6,093	6,159	6,224	6,290
30										5,637	5,700	5,763	5,827	5,890	5,953	6,017	6,080
31									5,394	5,455	5,516	5,577	5,639	5,700	5,761	5,823	5,884
32								5,166	5,225	5,284	5,344	5,403	5,463	5,522	5,581	5,641	5,700
33							4,952	5,009	5,067	5,124	5,182	5,239	5,297	5,355	5,412	5,470	5,527
34						4,750	4,806	4,862	4,918	4,974	5,029	5,085	5,141	5,197	5,253	5,309	5,365
35					4,560	4,614	4,669	4,723	4,777	4,831	4,886	4,940	4,994	5,049	5,103	5,157	5,211
36				4,381	4,433	4,486	4,539	4,592	4,644	4,697	4,750	4,803	4,856	4,908	4,961	5,014	5,067
37			4,211	4,262	4,314	4,365	4,416	4,468	4,519	4,570	4,622	4,673	4,724	4,776	4,827	4,878	4,930
38		4,050	4,100	4,150	4,200	4,250	4,300	4,350	4,400	4,450	4,500	4,550	4,600	4,650	4,700	4,750	4,800
39	3,897	3,946	3,995	4,044	4,092	4,141	4,190	4,238	4,287	4,336	4,385	4,433	4,482	4,531	4,579	4,628	4,677
40	3,800	3,848	3,895	3,943	3,990	4,038	4,085	4,133	4,180	4,228	4,275	4,323	4,370	4,418	4,465	4,513	4,560
41	3,707	3,754	3,800	3,846	3,893	3,939	3,985	4,032	4,078	4,124	4,171	4,217	4,263	4,310	4,356	4,402	4,449
42	3,619	3,664	3,710	3,755	3,800	3,845	3,890	3,936	3,981	4,026	4,071	4,117	4,162	4,207	4,252	4,298	4,343
43	3,535	3,579	3,623	3,667	3,712	3,756	3,800	3,844	3,888	3,933	3,977	4,021	4,065	4,109	4,153	4,198	4,242
44	3,455	3,498	3,541	3,584	3,627	3,670	3,714	3,757	3,800	3,843	3,886	3,930	3,973	4,016	4,059	4,102	
45	3,378	3,420	3,462	3,504	3,547	3,589	3,631	3,673	3,716	3,758	3,800	3,842	3,884	3,927	3,969		
46	3,304	3,346	3,387	3,428	3,470	3,511	3,552	3,593	3,635	3,676	3,717	3,759	3,800				
47	3,234	3,274	3,315	3,355	3,396	3,436	3,477	3,517	3,557	3,598	3,638	3,679					
48	3,167	3,206	3,246	3,285	3,325	3,365	3,404	3,444	3,483	3,523	3,563						
49	3,102	3,141	3,180	3,218	3,257	3,296	3,335	3,373	3,412	3,451	3,490						
50	3,040	3,078	3,116	3,154	3,192	3,230	3,268	3,306	3,344								
51	2,980	3,018	3,055	3,092	3,129	3,167	3,204	3,241									
52	2,923	2,960	2,996	3,033	3,069	3,106	3,142										
53	2,868	2,904	2,940	2,975	3,011	3,047											
54	2,815	2,850	2,885	2,920	2,956												
55	2,764	2,798	2,833	2,867													
56	2,714	2,748	2,782														
57	2,667	2,700															
58	2,621																

 Pinion

 Spur

 Possible ETS mandatory ratio combinations

Quick info